

## What is an Important Cultural Property?

An Important Cultural Property is a designation assigned to property by the Japanese Government (The Minister of Education, Science and Culture) in accordance with the Law for the Protection of Cultural Properties. These structures, located in Japan, have particular significance academically and in terms of cultural history. The designation may also be assigned to tangible cultural properties among which are works of art or handicrafts.

## Reminder for Visitors

- The *kyu* Asakura House is an Important Cultural Property. Please take care not to soil or damage the building, exhibits, or plants.
- Shoes must be taken off before entering the building. Also, the use of slippers is prohibited in the interest of preserving the facility.
- Some rooms are off-limits due to requirements related to the preservation of the facility. Taking photographs and videos for commercial purposes are restricted and require separate procedures.
- Open flames, food, and beverages are prohibited within the facility.
- The House, being an Important Cultural Property, is not barrier free. Please be aware that assistance will be needed if visiting in a wheelchair.
- Visitors are not permitted to bring animals inside the building or garden.

## second floor

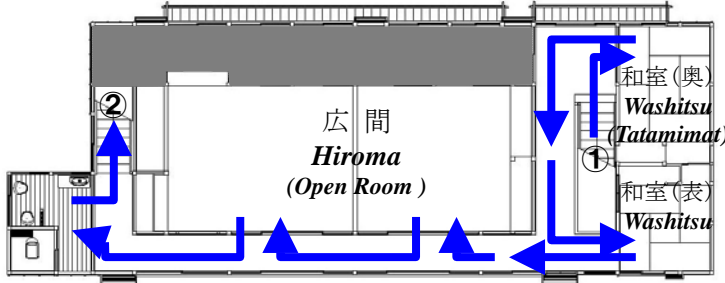

## first floor

- ➡ Suggested Route
- Restricted Area

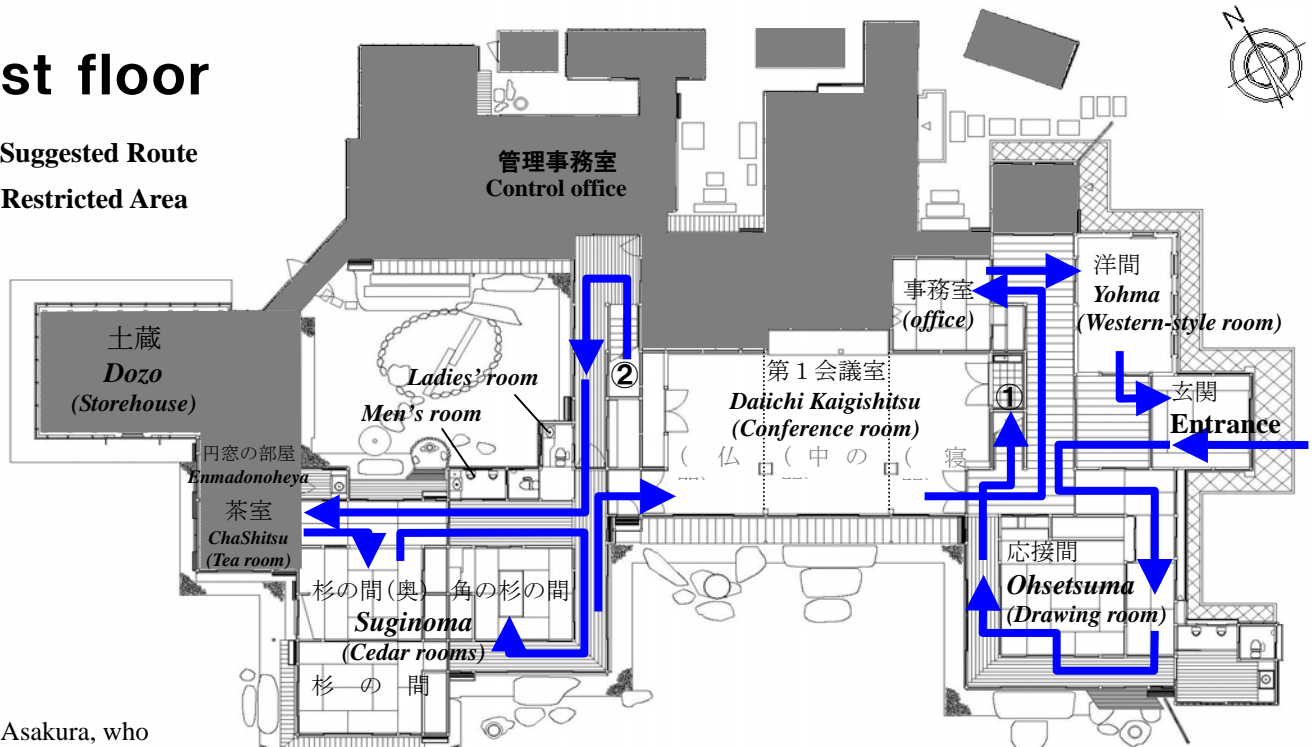

Torajiro Asakura, who served as the Chairman of Tokyo's Prefectural Assembly, followed by serving in the Shibuya City Assembly, built the house as his private residence on the southwest slope of Sarugakucho in 1919. (The eighth year of the Taisho era)

## Description:

The *kyu* Asakura House's main building stands on the north side of the property, with a storehouse on the west and a garden gate and garage on the east. Most of the flooring of the two-story main building is tatami. The roof is clay-tile and the exterior is clapboard with some sections in stucco. The house is a remarkable example of mansions built during the Meiji era until the 30<sup>th</sup> year of the Showa era.

The first floor was originally used for the family's daily living. When they had a special event, they would greet their guests in the *Ohsetsuma* (drawing room), located on the left-side of the entrance.



*Suginoma*(Cedar rooms)

The *Yohma* (western style room), located on the right-side of the entrance, was used for visitors and as a butler's office. The rooms on the north-side of the main building were used by the family and housemaids. Being in an official position, Torajiro used the second floor for meetings. The *Suginoma* (Cedar rooms) on the west side of the building are beautifully designed in the *Sukiya-zashiki* style and show off the cedar grain and texture. Torajiro would use this area to meet his private guests coming to make petitions.

## The Garden

The Japanese garden at the *kyu* Asakura House follows the cliff line in the design of its paths. The stone lanterns, landscaped rocks and other decorative items enliven the garden. The garden is especially beautiful during the spring and fall.



*Garden in fall*